

Reference : C-28H30 8-8

The Fixolite box is a 6 m long prefabricated lintel box designed to receive a closure (roller shutter, BSO, etc.). The box consists of an inverted U-shaped, fire-retardant expanded polystyrene (30 kg/m³ density) shell reinforced with steel mesh. The side walls are fitted with aluminum rails.

Traditional model box

The most economical solution while still offering good performance.

Certified by a Technical Approval from CSTB.

Maximum length: 160 cm structural opening (184 cm overall).

Packaging: pack of 28 (or 56) boxes, 6 ml each.

Type	28H30
Outer rail ref.	827
Inner rail ref.	827
Color	Blue polystyrene
Compatible cheek	J-28
Certification	CSTB 16-11-634 (translated) [PDF]
Thermal conductivity	U = 0.9 W/m ² .K
Thermal resistance*	R = 1.11 m ² .K/W

(* R: thermal resistance (m².K/W) taking into account a λ coefficient of 0.0374 W/m.K after application of a safety coefficient of 1.15.

Weight	1.99 kg/m
Reaction to fire	class E (EN ISO 11925-2/EN 13 501)
Air permeability	c*3 class
Acoustic perf. (Dn _W)	49 dB

Box dimensions

Width	280 mm
Height	295 mm
Tunnel	230 mm
External side	25 mm
Internal side	25 mm

Components

Aluminium (recycl. 85%)	0.57 kg/m
Steel (recycl. 96.5%)	0.76 kg/m
Polystyrene (recycl. 10%)	0.66 kg/m
Total	1.99 kg/m

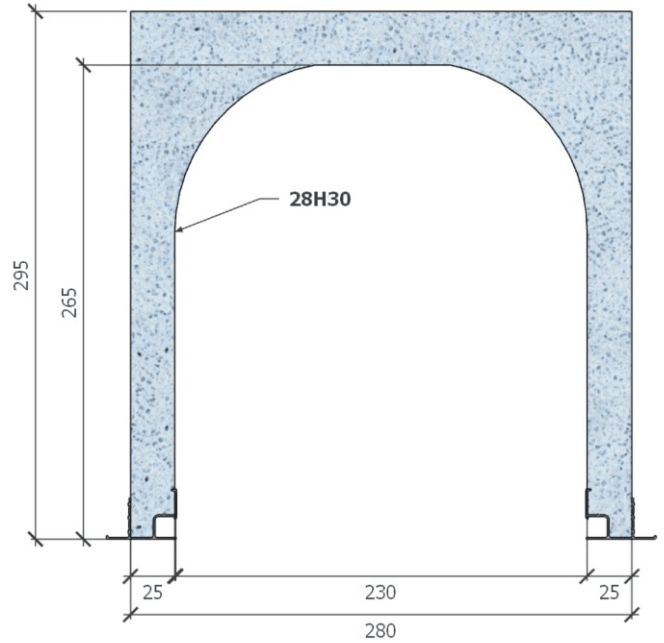

Sides finishing

External side

Ribbed polystyrene



Internal side

Ribbed polystyrene



Rail diagram

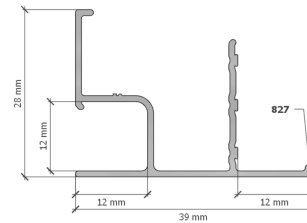
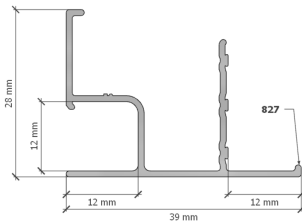

English



Français



2025-11 • Fixolite Disclaimer. The information provided in this technical sheet is for reference only and without warranty of accuracy or completeness. Fixolite disclaims any liability for errors, omissions, or consequences related to the use of this information. Specifications are subject to change without notice.

Check out our [installation instructions \[PDF\]](#) and [general documentation](#)